

Columbus Stainless VPN Solution

PaloAlto GlobalProtect Agent

NOTE: You can install apps from all the registered app stores onto Android and Apple devices to enable VPN function from your mobile devices as well. You can also install onto a Mac OS X by way of the download from the portal. The rest of this procedure is specific for Windows 7/8/10. If you have an older version of Windows you will need a different client version. Please contact me for a link to the download. As part of all the above installs the software will ask you for the “portal” which is: ***vpn2.columbus.co.za***

Installing the client software on Windows 7/8/10

1. Ensure you have an active Internet connection.
2. Open your browser (Internet Explorer, Edge, Firefox or Chrome) and go to the following URL: <https://vpn2.columbus.co.za/>. *(Please note this URL may change in the future.)*



- 3.
4. At the login prompt enter your Columbus Corporate Windows username (no domain necessary) and current Windows password to log in.



- 5.
6. You need to install the GlobalProtect Client on your PC/MAC. Click on the relevant version to download and install.
7. Optional: How to know on Windows you are running 32bit vs 64bit?
 - a. Open Windows Explorer and right-click on “This PC” or “My Computer” and then click on “Properties” as is shown below.

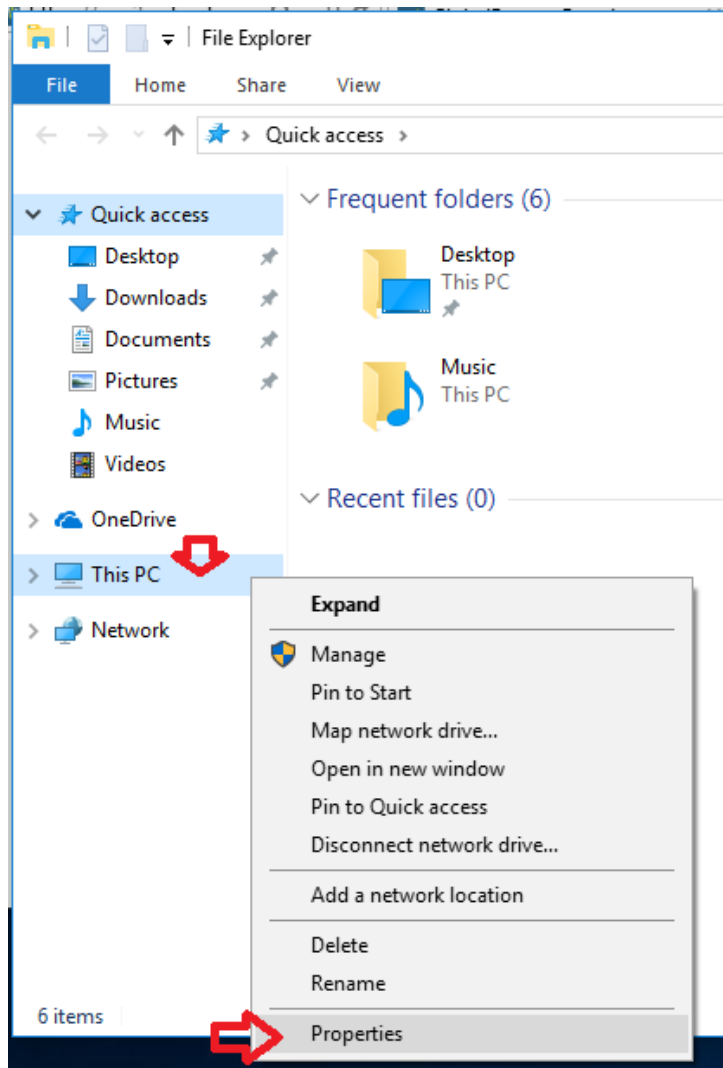

b.

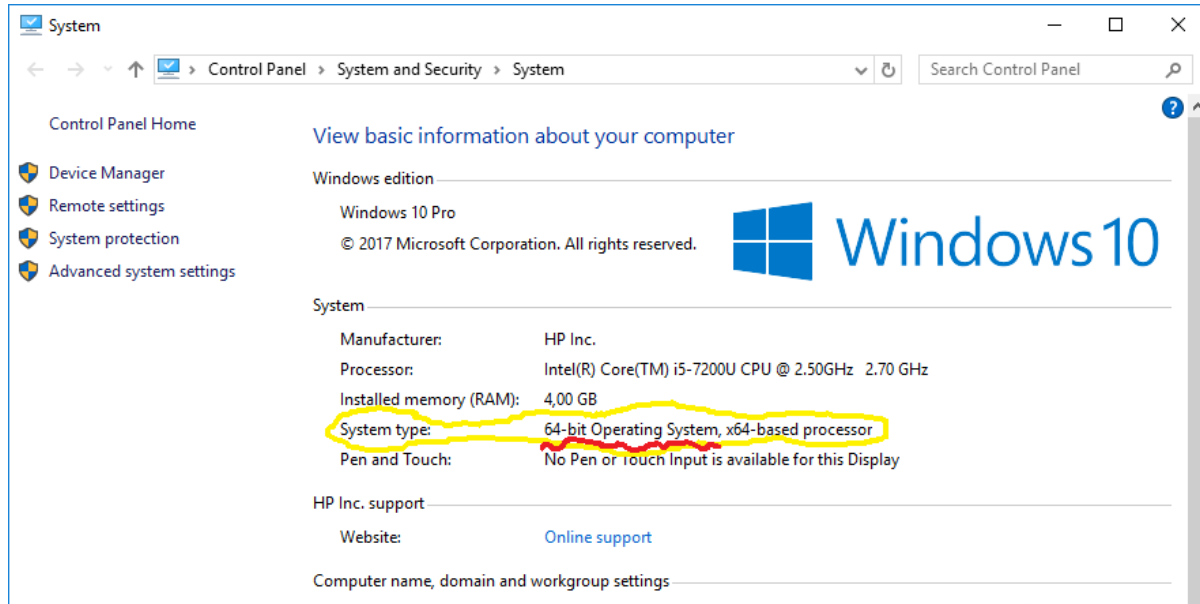

c.

d. On System Type a 64bit operating system will clearly state 64bit. If it does not state 64bit then it will be 32bit.

8. Continue to download the correct version:

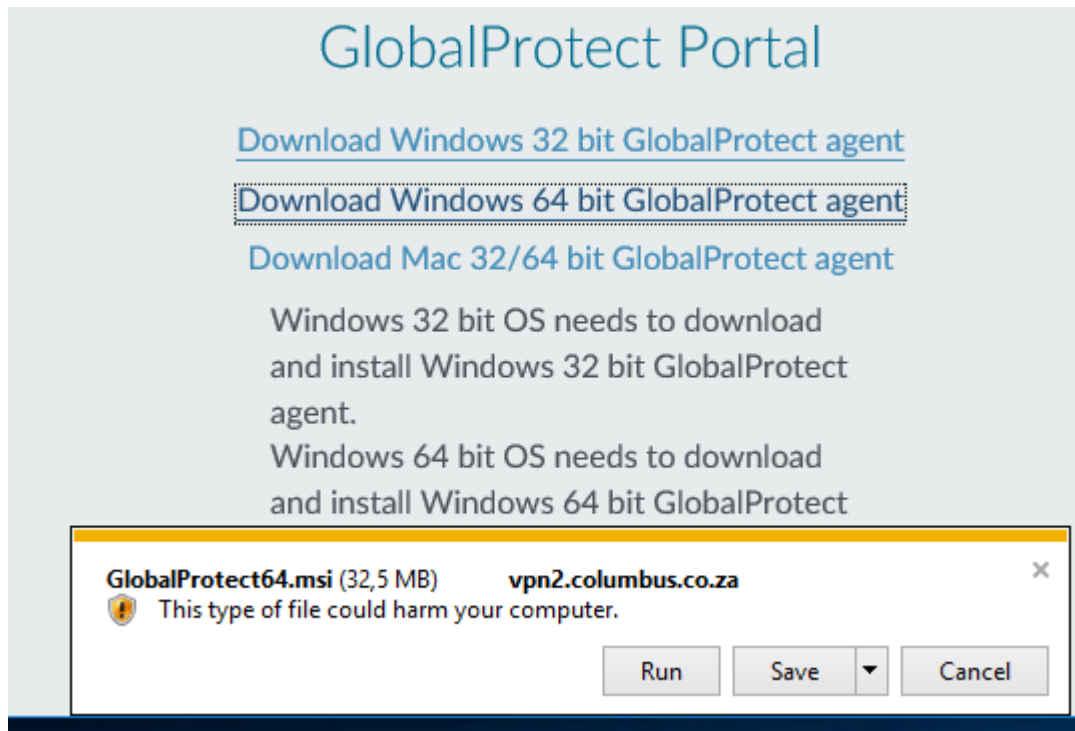

Choose "Run"

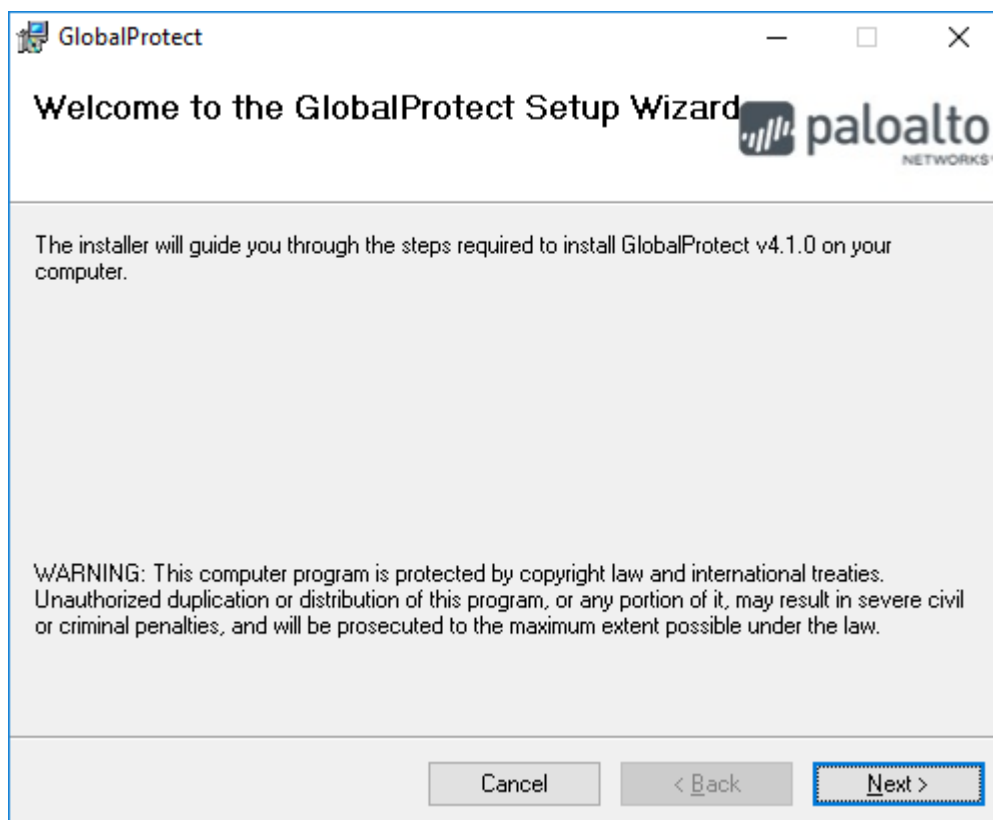

- 9.

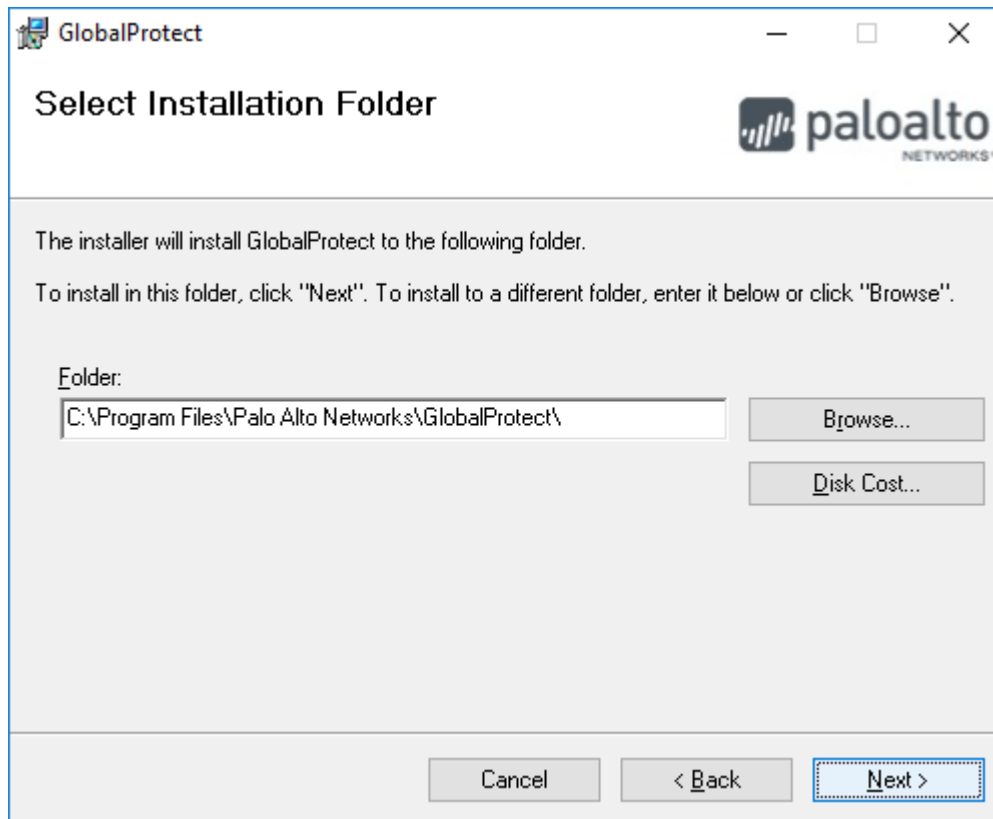

10.

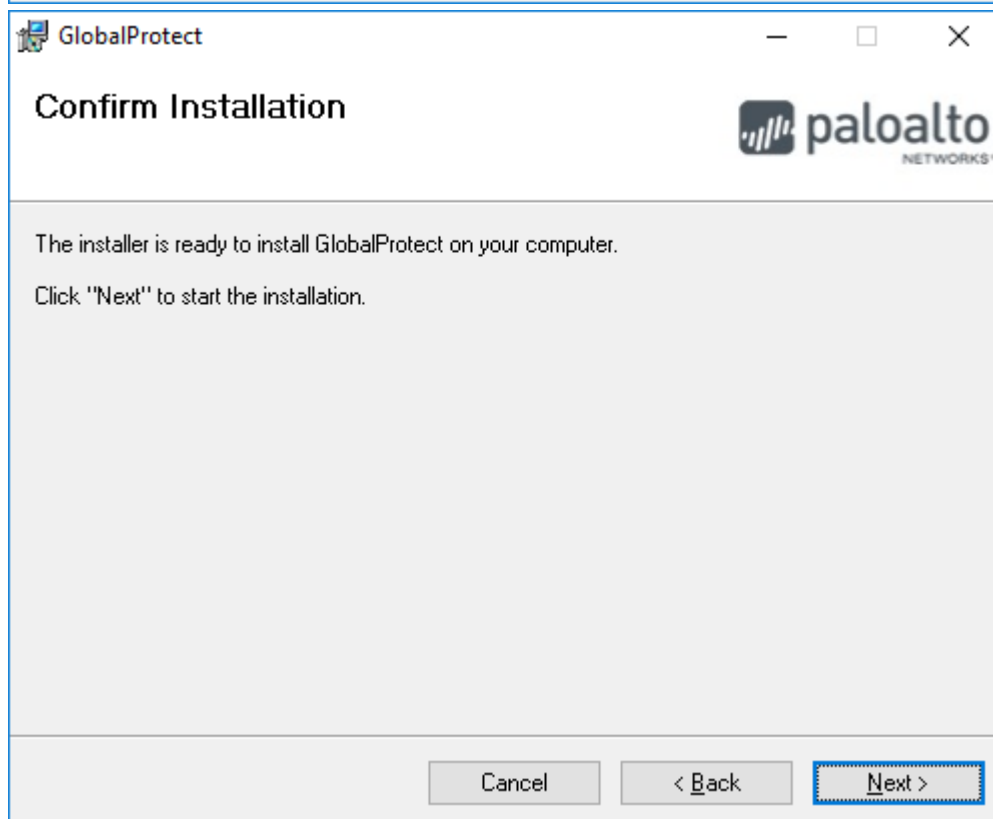

11.

12. Windows should prompt you to allow this installer to make changes to your machine. Please allow the changes.

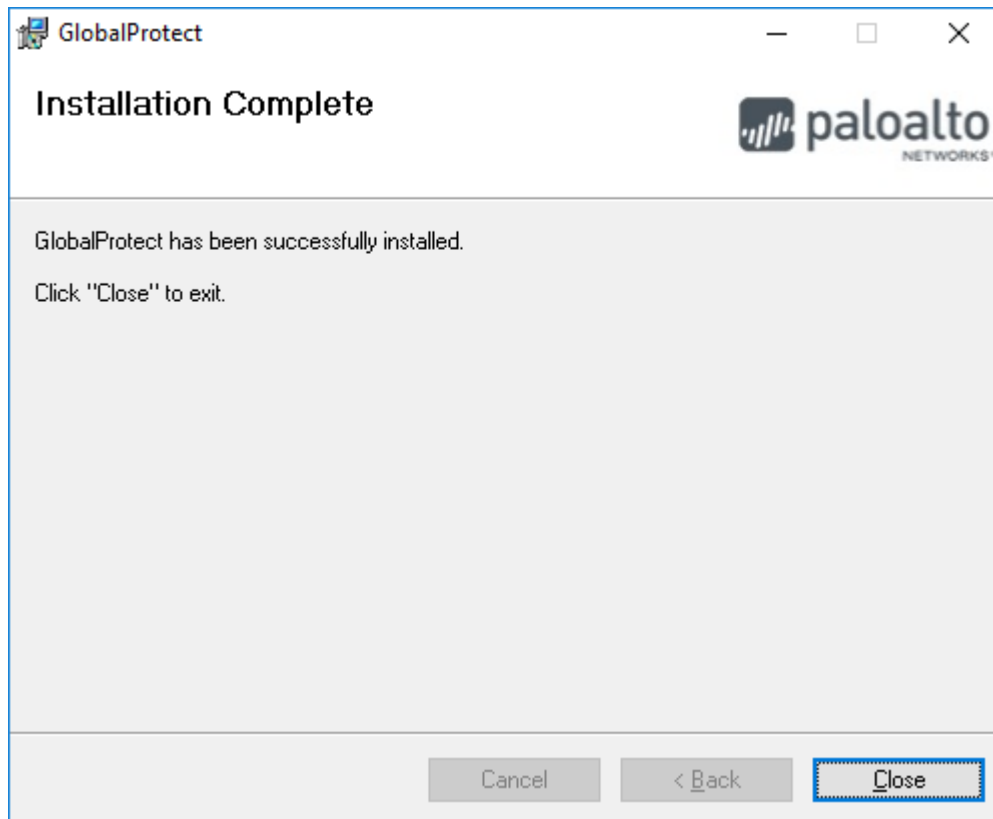

- 13.
- 14. Once completed you will see the pop-up box of GlobalProtect that prompts you for the portal address. This is currently vpn2.columbus.co.za but may change later.
- 15. The client will always be present in the notification area on your task bar (icons next to you time/date)



It is the icon that looks like the round earth/globe while it is not connected to the VPN. When it is connected it will have a little shield imposed on the earth.

- 16. Click on the icon to activate it.

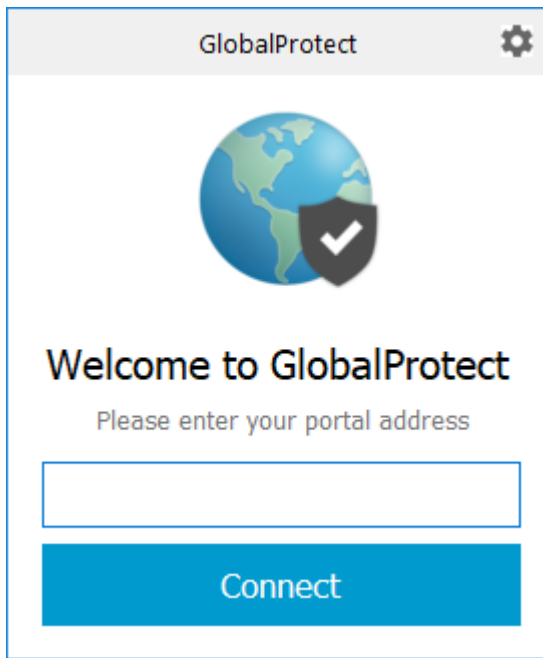

17.

18. Fill in the portal address as given above.

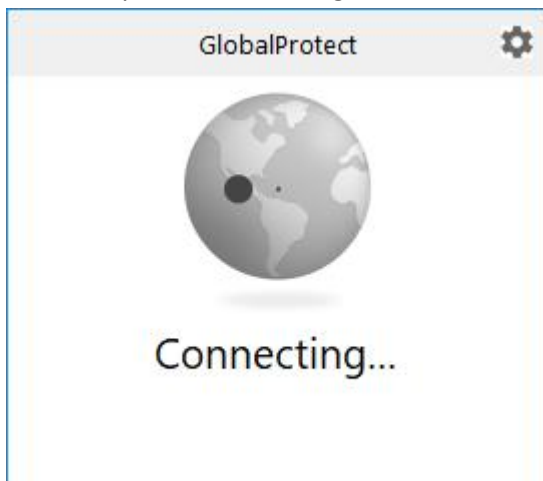

19.

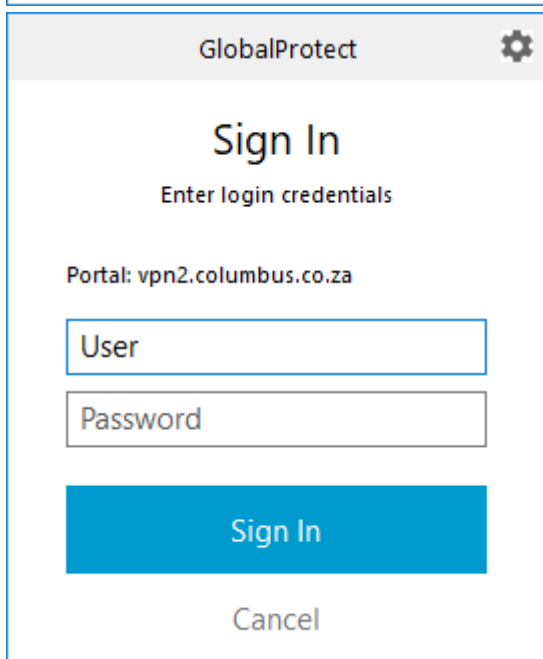

20.

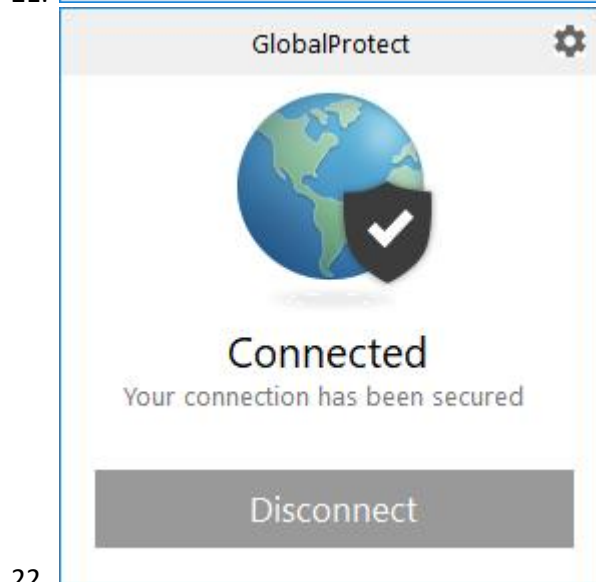
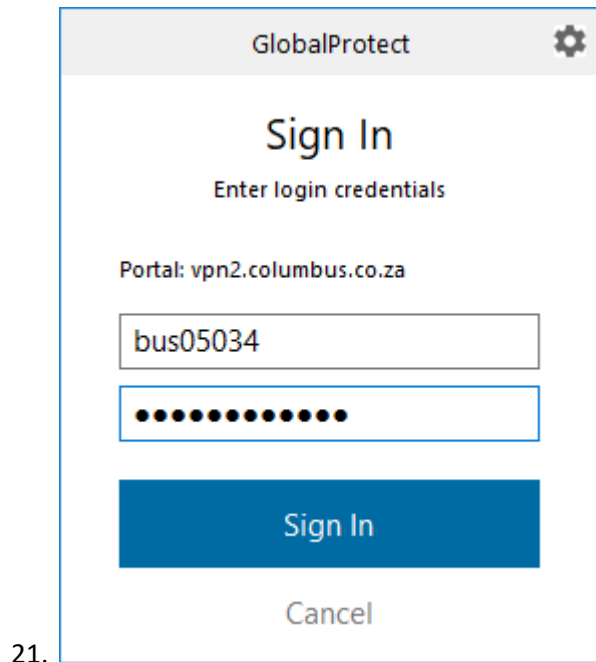

23. You are connected and can work as per normal.
24. If you are having problems connecting to a system then please try connecting to the FQDN address (e.g. gen01.corporate.columbus.co.za instead of just gen01).